

Uninterruptible Power Supply

AirGO Pro adopts dual-power design, with two exchangeable batteries to supply power. One of the batteries can be removed when the other is still powering the device during scanning. It ensures an uninterruptible power supply for a smooth 3D scanning.



Battery capacity: 6000 mAh
Battery life: Dual batteries for uninterruptible power supply

Technical specification

Type	AirGO Pro
Supported software	ScanViewer, Tviewer
Dimension	164 x 159 x 87 mm
Weight	0.8 kg
Battery capacity	6000 mAh
Operating temperature	-10°C ~ 40°C
Operating humidity	10 ~ 90% RH
Battery life	Dual batteries for uninterruptible power supply
Wireless network	Wi-Fi 6 (802.11ax)
Supported equipment	KSCAN series, AXE series, TrackScan series, SIMSCAN series
Patent	CN209327898U

SCANTECH™

AIRGO PRO

New Superpower for Wireless 3D Scanning



SCANTECH (HANGZHOU) CO., LTD
Building 12, No.998, West Wenyi Road, Yuhang District, Hangzhou,
Zhejiang Province, China
Tel: 0086-571-85852597 Fax: 0086-571-85370381
E-mail : info@3d-scantech.com
Website : www.3d-scantech.com

SCANTECH™

Copyright ©

SCANTECH (HANGZHOU) CO., LTD

AIRGO PRO

AirGO Pro, a new generation of smart wireless communication link, specially designed for mobile 3D scanning in areas with no power supply. It saves the trouble of connecting 3D scanners to computers by cable in harsh environments, allowing true freedom in wireless 3D scanning.

AirGO Pro is highly compatible to support different types of handheld scanners. Its onboard processor can compute and store massive scanned data. The data can then be transferred to a computer via Wi-Fi 6. With the help of projecting software and AR glasses, users can monitor the scanning progress in real time. With two exchangeable batteries, the AirGO realizes an uninterrupted power supply.

Light and Portable Design for Mobile 3D Scanning

AirGO Pro is a wearable device that allows unlimited mobile 3D scanning. Its lightweight and portable design enables users to break the limitations posed by some working conditions and the objects to be scanned. Users can 3D scan middle-to-large-scale objects anywhere without power supply.



Wireless and Real-time Data Transfer

AirGO Pro supports real-time and wireless data transfer. It allows users to transfer scanned data to a computer wirelessly for viewing, post-processing, and storage.

Wireless network: Wi-Fi 6 (802.11ax)

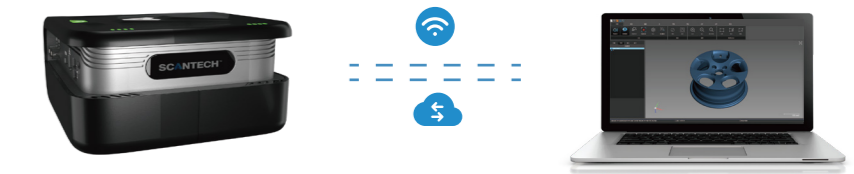

Immersive Data Visualization

With AR glasses or projection software, an immersive data display will be achieved.



High-efficiency Processing of Massive Data

AirGO Pro has an onboard ultra-fast processor capable of processing massive data, despite its compact size (164 x 159 x 87 mm).

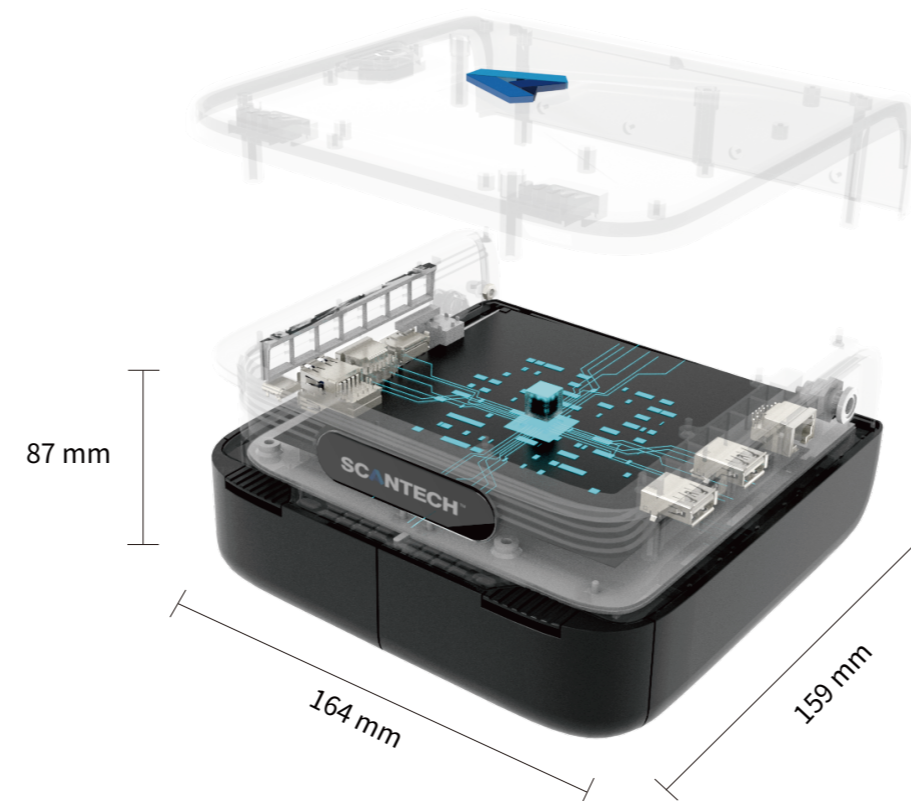

Seamless Integration with Scantech's 3D Scanners

It is compatible with various handheld 3D scanners, whose scanned data can be transferred to computers in real time for post-processing.



KSCAN
Experience Diverse Ultimate from Metrology Measurement



SIMSCAN
Small Is the Brand-New Big



AXE
Measuring An Ultra-wide 3D world



TRACKSCAN
Intelligent 3D Tracking with Unrivaled-fast Measurement

